

MX6500N MX7500N



THE RENAISSANCE OF COLOUR

DYNAMIC PERFORMANCE WITH EXCEPTIONAL OPERABILITY



the **SHARP** experience

see what happens

SHARP

The new Sharp Pro Series Colour Document Systems deliver breakthrough performance and unmatched versatility.

SUPERIOR IMAGE QUALITY WITH PRODUCTIVE FEATURES

versatility

The **MX6500N** and **MX7500N HIGH PERFORMANCE COLOUR DOCUMENT SYSTEMS** offer exceptional productivity, professional features and world-class image quality at **SPEEDS UP TO 75 PPM**.

Designed for busy in-plant and on-demand workflow environments, these new models combine a versatile, modular design with a wide range of supported media and powerful output capabilities that can help your business produce more jobs in-house and improve profitability.

Key Features

- **EDGE-TO-EDGE PRINTING** enables operators to output high quality, full-bleed booklets in-line, helping to reduce outsourcing costs as well as production time.
- A powerful external **Fiery® Colour Print Server with Command WorkStation®** is available for colour critical environments that need precision job management. Command WorkStation is fully integrated with the Sharp touch-screen for unmatched control and ease-of-use.
- Sharp's exclusive **TRIPLE AIR-FEED PAPER HANDLING** option provides higher reliability for maximum uptime as well as enhanced media support, and is virtually maintenance free.

The MX6500N and MX7500N also support **SHARP OSA® TECHNOLOGY**, which makes integration with network applications and cloud services simple and easy. Sharp's industry-leading security platform incorporates standard **256-BIT DATA ENCRYPTION** and overwrite protection to help safeguard your business's intellectual property. And when it comes time to trade in, a convenient End-of-Lease feature can erase all job data and user data.

That's the **SHARP DIFFERENCE**.



ENGINEERED TO MAXIMIZE OUTPUT EFFICIENCY



FULL-BLEED
EDGE-TO-EDGE PRINTING

AVAILABLE
FIERY COLOUR
PRINT SERVER

TRIPLE AIR-FEED PAPER
HANDLING OPTION

An advanced design plus multi-function capability
allow you to meet tomorrow's document needs today.

- Flexible modular design provides a **wide variety of configurations** from basic high-speed copying and printing to professional folding and **booklet making**
- 150-sheet **Duplex Single Pass Feeder (DSPF)** scans documents at up to 150 images per minute
- Up to **13,500-sheet paper capacity** supports media **up to 110 lb. cover stock (300 gsm)** and up to 13" x 19" output
- **On-board paper catalogue** stores up to 1,000 media profiles to help streamline job set-up and maintain optimum output quality
- Sharp's **Colour Consistency System** with next generation image process control delivers high-quality colour output and maintains optimum colour balance and toner density page after page
- Standard **PCL®6** and **true Adobe® PostScript®3™** with available Windows® XPS printing systems
- **Large 15.4"** (diagonally measured) high-resolution **colour touch-screen display** with integrated keyboard



MX7500N shown with Fiery Command WorkStation fully integrated at the Sharp control panel.

- True **1200 x 1200 dpi** printing with 8-bit processing provides beautiful images and enhanced clarity for fine details such as small text and graphics
- Standard **Job Management** features make it easy to print on-demand as well as retain jobs, combine jobs, repaginate jobs, edit pages and more
- **Energy efficient** belt fusing offers **low power consumption**, fast warm up time, enhanced print quality and greater media capabilities
- Supports Sharp's award-winning security platform with standard **256-bit data encryption** and up to 7 times **data overwrite protection**
- Convenient **End-of-Lease feature** can erase all files on the hard disk drive, all user data, job status data and address book data at trade-in time

PROFESSIONAL FEATURES THAT ENHANCE PRODUCTIVITY

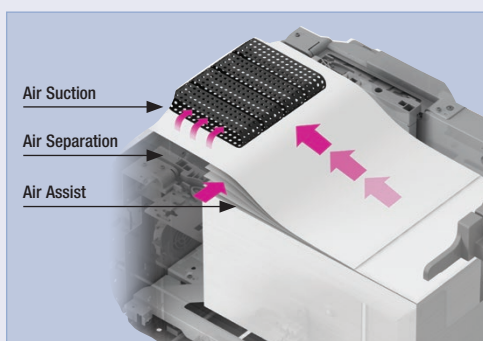

Triple air-feed LCT paper trays maximize reliability and minimize downtime. Pneumatic sensors maintain consistent air flow.



Produce high quality full-bleed colour booklets up to 80 pages with the MXFN22 Saddle-Stitch Finisher, or up to 120 pages with the Plockmatic Booklet Maker System.

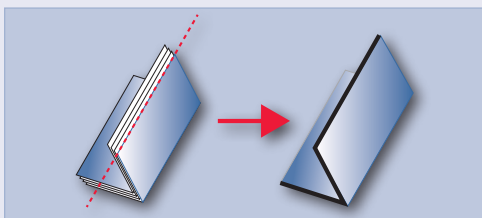

The MXTM10 Trimmer Unit option for the MXFN22 Saddle-Stitch Finisher can cut the folded open edge for a smooth, straight, finished look.

Production class paper handling, full-bleed printing, with versatile in-line finishing – the MX6500N/7500N capabilities will exceed your expectations.

High Performance Paper Handling with Air-feed Technology

Sharp understands the importance of productivity, that's why the new MX6500N and MX7500N Pro Series Colour Document Systems offer up to **13,500-sheet paper capacity** and support **media types up to 110 lb. cover (300 gsm), even when duplexing!** Sharp's advanced large capacity paper tray option uses air-feed technology, which minimizes downtime. A feature typically found on printing presses, the triple air-feed system directs air flow with precision accuracy to ensure proper paper handling. A standard dual head document feeder can scan up to **150 images per minute**.



13,500-sheet paper capacity with available options.

Print full-bleed High Quality Colour Booklets In-line

With the MX6500N/7500N innovative **edge-to-edge printing** feature, operators can produce compelling **full-bleed colour booklets** up to 80 pages. Sharp makes it easy with the available MXFN22 Saddle-Stitch Finisher and MXTM10 Trimmer Unit. For even more productivity, choose the Plockmatic Booklet Maker System, which can **produce up to 120-page saddle-stitch or square fold spine booklets**. Help reduce outsourcing costs as well as production time by producing high quality full-bleed booklets in-house.

MXFN22
Saddle-Stitch
Finisher





OUTSTANDING COLOUR QUALITY-HIGH PERFORMANCE OUTPUT

With the available MXPE10 Fiery Colour Print Server, the Sharp Pro Series Colour Document Systems becomes a powerful integrated solution for managing professional in-plant and busy on-demand printing environments.

- Easily manage jobs with Fiery® Command WorkStation® fully integrated at the Sharp control panel for unmatched control and ease-of-use
- Deliver high impact documents with vibrant colour fidelity that maintains consistent results page-after-page
- Process large, complex jobs at speeds up to 75 ppm that will exceed your expectations

Better Productivity with Higher Performance

The powerful architecture of the MXPE10 Fiery Server **shortens turnaround times**, while helping companies produce professional-looking finished jobs that win them new business and get their customers noticed.

Outstanding Colour Across Applications

In demanding environments, achieving accurate colour every time is critical. The integrated Fiery colour management tools provide **superior colour control** out of the box. Customers who routinely use transparencies, and other effects such as drop shadows, can rest assured that their designs will be printed correctly.

Centralized Control and Automated Management

The MXPE10 Fiery Server offers a **centralized solution** that features the award winning Command WorkStation®. Its interactive WYSIWYG interface enables operators to monitor, control and troubleshoot production from multiple desktops or locally at the Fiery Server directly from the Sharp Pro Series touch-screen.

Industry-Leading Production Print and Variable Data Tools

The MXPE10 Fiery Server offers optional make-ready tools and driver-based imposition with Booklet Maker, to efficiently handle many production processes. It enables customers to **produce short-run jobs profitably** by automating manual tasks, and increases workflow flexibility by supporting industry-leading variable data printing (VDP) formats including PPML and the new PDF/VT-1 and 2 formats.

Integration with Third Party and Other EFI Solutions

The MXPE10 Fiery Server uses the Adobe PDF Print Engine (APPE) v2.5 rendering technology to offer a native end-to-end PDF workflow. The Fiery open platform also supports industry standards and **seamlessly integrates with existing MIS environments**, third-party vendors and other EFI MIS solutions.



MX7500N shown with Fiery Command WorkStation fully integrated at the Sharp control panel.



The MXPE10 Fiery Server installation includes a touch pad for the Sharp Pro Series Document Systems.



Flexibility

The MX6500N and MX7500N Pro Series Colour Document Systems utilize a powerful multi-processor controller designed to quickly execute complex print and copy jobs in busy production environments at speeds up to 65 ppm and 75 ppm respectively.

High Quality Professional Output

Produce brilliant colour documents as well as compelling black and white documents with crisp razor-sharp graphics. True 1200 x 1200 dpi resolution with 8-bit processing helps ensure all your documents will look great.

Multi-Folding Unit

Provides a variety of folds, including Z-fold, C-fold, Accordion fold, Double fold and Half fold.

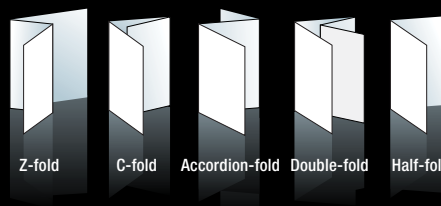

Plockmatic Production Booklet Maker System

Produces 120-page full-bleed, square-fold spine booklets in-line at engine speed.

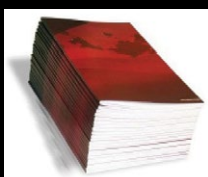

Versatile Finishing Options

Two powerful finishing systems are available – a 4,000-sheet stacking finisher with 100-sheet stapling capacity or a 4,000-sheet saddle-stitch finisher, which can produce up to 80-page full-bleed booklets with the available face trimmer unit.

GBC® SmartPunch Pro™

Professional punching system produces up to seven commonly used punch styles for creating professional bound booklets.

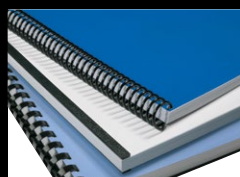

5,000-Sheet Stacker

For high volume post process jobs add the 5,000-sheet stacker with standard paper cart. Connect two stackers in tandem (as shown) for unattended output of up to 10,000 sheets.



HIGH IMPACT VERSATILITY AND SCALABILITY

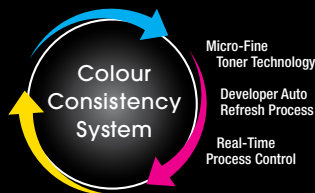

Colour Consistency System

Sharp's Colour Consistency System combines Micro-fine Toner Technology with advanced Developer Refresh Technology and next generation Image Process Control. This synergy of processes helps ensure colour output is at peak performance page-after-page and job-after-job.

Convenient Job Management

1TB hard disk drive provides on-board document storage. An intuitive thumbnail view makes it easy to select, edit, reprint, repaginate and more.

Post Sheet Inserter

Produce professional looking documents with pre-printed covers and chapter inserts with the available post sheet inserter.

Integrated Network Scanning

Sharp's ImageSEND™ feature provides one-touch document distribution. Scans to multiple destinations, including E-mail, FTP, Network Folder (SMB and Home Directory) and USB.

Duplexing Single Pass Feeder (DSPF)

Standard 150-sheet dual head document feeder scans both sides of a document in a single pass at up to 150 images per minute (IPM). This system helps maximize both efficiency and reliability.

15.4" (diagonally measured) Touch-screen

A large, high resolution touch-screen with tablet-style navigation makes it easy to access features. You can also add shortcut keys to popular features, change the key layout or add a custom background theme.

500-Sheet Multi-Bypass

Feeds paper sizes from 5-1/2" x 8-1/2" to 13" x 19".

Independent Motors

Insulated independent motors run quieter and provide higher reliability.

3,000-Sheet Standard Paper Capacity

Includes 2,000-sheet letter size tandem tray and two 500-sheet letter/legal/ledger size trays. Add optional paper handling accessories for a maximum on-line paper capacity of 13,500 sheets.

Rigid Frame Construction

Offers increased durability and reliability to withstand heavy use.

Superior Media Handling

Sharp's advanced 5,000-sheet large capacity paper tray option utilizes triple air-feed technology, which directs air flow with precision accuracy for proper paper handling and enhanced media support up to 300 gsm. Two large capacity trays can be connected in tandem (as shown).

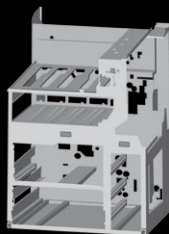

CONFIGURATIONS TO SUIT VIRTUALLY ANY ENVIRONMENT

Versatile and Customizable To Fit Your Needs

The MX6500N/7500N Pro Series Colour Document Systems offer flexible paper handling and finishing options to accommodate any size in-plant or on-demand workflow environment.*



MX7500N shown with 3,500-sheet large capacity cassette, 100-sheet Staple/Saddle Finisher and 100-sheet bypass tray.



MX7500N shown with Curl Correction Unit, Inserter, Multi-Folding Unit, GBC SmartPunch Pro, 100-sheet Staple/Saddle-Stitch Finisher, dual 5,000-sheet large capacity trays, dual 5,000-sheet paper stackers, 500-sheet multi-bypass tray and status indicator.

Modular Options Make It Easy To Build the System of Your Choice

Options for the MX6500N/7500N enable businesses to choose from several high performance finishing systems that offer up to 100-sheet stapling, professional saddle-stitch booklet making and three-hole punching. More advanced configurations include a square-fold spine Booklet Making System, a professional punching system, high capacity paper stackers, a two-tray inserter, a multi-folding unit and a trimmer unit.

Customize

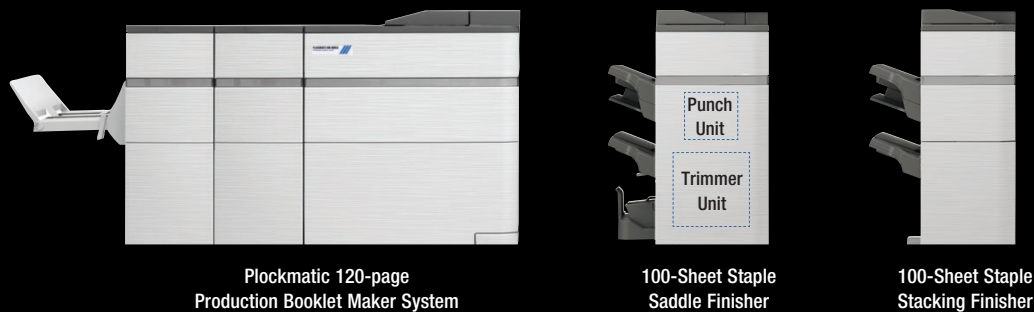

*Some options not available in all configurations, see your local dealer.

GET MORE OUT OF NETWORK RESOURCES

Streamline your document workflow and enhance productivity with Sharp OSA technology.

Integrating with Network Applications and Cloud Services Has Never Been So Easy

With standard Application Communication and External Accounting modules, the MX6500N/7500N colour series offers **powerful document workflow capabilities** to help businesses leverage their network infrastructure, cloud-enabled services and more.* While others are limited to a small circle of productivity, the Sharp OSA development platform allows businesses to leverage the power of their network applications, back-end systems, even cloud-enabled services, right from the touch-screen panel of this new series.

Save Time, Increase Efficiency

You'll save time and increase the efficiency of everyday tasks with Sharp OSA technology because it can be virtually seamless to the user. Any MX6500N/7500N anywhere in the organization can display choices that were once only available on a desktop PC. With **one-touch access** to business applications via Sharp OSA integration, you can start and finish a document distribution task without worry.

** Some features require optional equipment.*

Customized Integration

Sharp OSA technology also provides **powerful customization**. With the ability to personalize applications and processes specific to your business, Sharp OSA technology can help eliminate redundancy and **streamline workflow**, helping to save time and **optimize productivity**. The latest version of Sharp OSA technology can reach beyond the firewall, enabling cloud-based applications over the Internet. And since Sharp OSA technology utilizes industry-standard network protocols and web APIs, third party software developers can deliver customized solutions to your business faster than ever.

The Convenience You Want with the Security You Need

The MX6500N/7500N colour series with the Sharp OSA development platform is the logical choice for providing fast, **flexible access to documents and applications**... no matter where you are in the office. You also get the controlled access and tracking ability you require with tighter integration capabilities for network security and accounting applications.



ADVANCED DEVICE MANAGEMENT TOOLS MAXIMIZE EFFICIENCY

The MX6500N/7500N Pro Series Colour Document Systems enhance operational efficiency through versatile device management.



Sharp Remote Device Manager (SRDM)*

Make management of your MX6500N/7500N simple and straightforward with Sharp Remote Device Manager (SRDM). This easy-to-use software allows you to take control of the versatile system features and simplifies installation and management.

- With **Printer Status Monitor**, network users can view printer conditions, check paper levels, toner, and more, all through an easy-to-use interface.
- With Sharp Remote Device Manager, administrators can easily manage the set-up, configuration, device settings and more. Advanced features such as **Remote Front Panel** allow administrators and support personnel to view and control the LCD panel of the machine remotely from virtually any PC on the network. Plus, with event-driven service alerts, administrators and supervisors can achieve higher productivity. Now it is easier than ever to view click counts, history reports and more.
- Experience the convenience of an **Embedded Web Page** right from your desktop. This advanced web-based management tool allows users to create and manage their own network scanning destinations, profiles and web-links. Administrators can access device settings, colour control, account information and security settings.

Take Charge of Colour Usage and Costs

With Sharp's device management system, administrators and supervisors can **define user groups** on the MX6500N/7500N to manage and restrict features, such as colour copying, scanning or printing. Easily set up a custom user group to manage page counts (copy, print, scan or fax operations) for both colour and B&W. This helps to simplify cost management of colour imaging. The MX6500N/7500N can store profiles for up to 1,000 users.

24/7 Training with My Sharp™

Managing all of the advanced features of your Sharp product is simple and easy. This dedicated customer training website is customized to your MX6500N/7500N and allows you to locate resources and find information specific to your configuration, truly helping you maximize your investment.



Remote Front Panel

Embedded Web Page

** Not available at time of launch.*

SAFEGUARD YOUR INTELLECTUAL PROPERTY

PRIVACY

AUTHORIZATION

CONFIDENTIALITY

PROTECTION



Sharp's Standard Key Security Features at a Glance

- 256-Bit Data Encryption
- Up to 7 times Data Overwrite Protection
- Group Account Management for up to 1,000 Users
- Confidential Printing
- Port Management
- IP/MAC Address Filtering

Innovative document and device protection helps ensure confidentiality.

To help protect your data, the MX6500N/7500N offers several layers of **Standard Security**, making Sharp the optimum choice to help protect employees' privacy and intellectual property. As a leader in office equipment security, Sharp makes it easy for virtually any business or government entity to safely deploy digital copying, printing, scanning and faxing.

Authority Groups

Advanced **Account Management** enables administrators to set authority groups for access to features of the MX6500N/7500N. Administrators can control which department, for instance, has full access to copying, printing and/or scanning. Walk-up users enter a code, Local Name and Password, or LDAP User Authentication to access the features assigned to their group.

Data Encryption and Overwrite

To help protect your data, the MX6500N/7500N can encrypt document data using **AES** (Advanced Encryption Standard) **256-bit encryption**. The MX6500N/7500N can also erase the temporary memory on the hard drive by overwriting the encrypted data up to seven times, offering an unprecedented level of assurance. A convenient **End-of-Lease feature** overwrites all data, including the Document Filing area, user data, job status data and address book.

Network Scanning Access Control

To help protect your network from unauthorized e-mail communications, the MX6500N/7500N supports **User Authentication**, requiring users to login before performing any network scanning operations.

Control Device Access Over the Network

To help restrict access to the device over the network, the MX6500N/7500N offers IPsec, SMB and extended support for **SSL Encryption** (Secure Sockets Layer), **IP/MAC** address filtering, IEEE 802.1x authentication, protocol enable/disable and port management for maximum security.

Documents Remain Confidential

The MX6500N/7500N offers **Confidential Printing**, which when used, requires users to enter a PIN code in order to print a queued document. To help protect your direct-print documents from unauthorized viewing, the MX6500N/7500N offers encrypted PDF printing and scanning.

Tracking and Auditing Information

Legislation and industry policies require companies to be more aware of information flow from their offices. Sharp offers both built-in and additional hardware/software which allows users to **control, access and track usage** of each device on the network.

Data Security Kit (Optional)

For maximum protection, the optional data security kit offers additional features, such as **Data Overwrite on-demand** and at power up, Document Filing access control, **Incorrect Password Lockout** and Restricted Status Display and Restricted List printing.

These scalable security offerings aim to protect your intellectual property, preserve confidential information and help your business to meet regulatory requirements, such as the Personal Information Protection and Electronic Documents Act (PIPEDA).



COMMITTED TO HELPING PROTECT THE ENVIRONMENT



Advanced Energy Saving Features

The MX6500N/7500N utilizes several energy efficient technologies to minimize power consumption and maximize energy savings.

- An LED exposure lamp reduces power significantly when compared to conventional exposure lamps.
- A customizable seven-day power management scheduler allows businesses to define the days and times when power will be turned on and turned off.
- Sharp's Auto Power Management function allows the device to be set to shut off automatically based on usage trends.
- Sharp's Eco-Scan mode can shut off the fuser when scanning documents, previewing images, faxing and other operations.

State-of-the-art belt fusing system consumes less power and shortens warm up time.

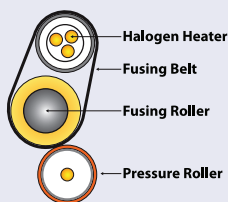

Sharp's environmental initiatives and dedication to developing energy efficient document systems set a high standard for the industry.

An Environmentally Responsible Approach to Product Design

The MX6500N/7500N Pro Series Colour Document Systems utilize Sharp's advanced **micro-fine toner technology**, which offers a lower consumption rate and produces less waste than conventional toners, resulting in longer replacement intervals. Sharp supplies are packaged using fully **recyclable materials**. Long-life consumable parts help minimize service intervals and downtime, resulting in lower operating costs. With two different energy saving modes, power can be reduced or shut off at set intervals. All Sharp document systems are **ENERGY STAR® qualified** and **RoHS compliant** to restrict the use of hazardous substances.

Toner Recycling Program

As part of our commitment to helping preserve the environment, Sharp offers customers a toner recycling program for all Sharp copiers and MFP products. Sharp encourages customers to recycle their used Sharp toner cartridges by providing a pre-paid shipping label for their return to our facility. Please visit <http://www.sharp.ca/en-CA/AboutUs/SharpAndTheEnvironment/Recycling.aspx> to learn more.

Environmental Leadership

As a testament to our commitment to the environment, Sharp is a three-time winner of the **ENERGY STAR®** annual **Excellence in Energy Proficiency Product Design**. Sharp was also a previous recipient of the **Excellence in Partnership Green Contractor Award** and the **Evergreen Award** from the General Services Administration (GSA) and the Coalition for Government Procurement. These awards recognize environmentally responsible businesses and their efforts on recycling, waste reduction and affirmative procurement practices.

Global Initiatives

Sharp is committed to environmental sustainability and corporate responsibility including planning, design, manufacturing, distribution and product end-of-life management. For more information about Sharp's environmental leadership including information about energy efficient products, electronics or toner cartridge recycling, please visit <http://www.sharp.ca/en-CA/AboutUs/SharpAndTheEnvironment.aspx> to learn more.

MX6500N/7500N SPECIFICATIONS

Main Specifications					
MX6500N/ MX7500N		Base models include, 150-sheet DSPF, 3,000-sheet paper capacity, 1-TB hard disk drive, PCL6/Adobe® PostScript® 3™ network printing, colour network scanning, web browser and swing-out keyboard. Includes Application Communication Module and External Accounting Module.			
Type	Light production, colour multi-function digital document system				
Display	15.4" (diagonally measured) colour dot matrix high-resolution touch panel tilting display. 1280 x 800 dots (WXGA)				
Functions	Copy, print, network print, network scan and document filing¹				
Copy System	Dry electrostatic transfer/Dual component developer/Magnetic brush development/OPC/Belt fusing/white LED exposure				
Original Size	Max. 11" x 17" sheets and bound documents				
Copy Size	Min. 5.5" x 8.5" (paper), Max. 13" x 19" (paper)				
Printable Area	Max. 13" x 19"				
Copy Speed	65/75 ppm B&W/Colour (8.5" x 11")				
Multiple Copy	Max. 9999 copies				
First Copy Time (in Seconds)²		MX6500N		MX7500N	
		B&W	Colour	B&W	Colour
	Platen Glass	4.0	5.6	3.7	5.1
	DSPF	6.5	9.2	6.3	8.8
Warm Up Time	90 seconds²				
Magnification	25% to 400% in 1% increments (with DSPF 25%-200%)				
Original Feed	150-sheet DSPF				
Scan Speed	DSPF Scan: Up to 150 IPM² (Monochrome); Up to 150 IPM² (Colour)				
Original Sizes	5.5 x 8.5", 8.5" x 11", 8.5" x 11" R, 8.5" x 14", 11" x 17"				
Paper Capacity	Std. 3,000 sheets/max. 13,500 sheets				
Paper Feed Sizes	Standard: Tandem Tray 1 - 1200 sheets (letter size), Tandem Tray 2 - 800 sheets (letter size), Trays 3/4 - 500 sheets each (letter/legal/ledger/statement/12" x 18", 13" x 19"), LCT (2-Drawer) - 2,500-sheets each drawer (letter/legal/ledger/12" x 18", 13" x 19"), Letter LCC - 3,500 sheets (letter), Ledger LCC: 3,000 sheets (letter/legal/ledger, 12" x 18", 13" x 19").				
Paper Weights and Types	Tandem Trays - 16-28 lb. bond (60-105 gsm), Trays 3/4 - 16 lb. bond to 100 lb. bristol (60-220 gsm), Multi-bypass Tray (for machine) - 15 lb. bond to 110 lb. cover (55-300 gsm), Multi-bypass Tray (for LCT) - 15 lb. bond to 100 lb. bristol (55-220 gsm), LCT (2-drawer) - 15 lb. bond to 110 lb. cover (55-300 gsm), Letter/Ledger LCC - 16 lb. bond to 100 bristol (60-220 gsm). Includes thin, plain, recycled, colour, letterhead, pre-printed and pre-punched, embossed and glossy paper.				
Duplexing	Standard automatic duplex copying and printing, supports up to 110 lb. cover (300 gsm)				
CPU	Multi-Processor Controller				
Interface	RJ-45 Ethernet (10/100/1000Base-T), USB 2.0 (2 host ports, front and rear), USB 2.0 (1 device port)				
Memory	Standard 5 GB				
Hard Disk Drive	1 TB				
Copy Resolution	B&W: 1200 x 1200 dpi (max.), Colour: 600 x 600 dpi (max.)				
Colour Modes	Photo, Full Colour Mode, Monochrome (B/W)				
Exposure Control	Modes: Text, Text/Photo, Text/Printed-Photo, Printed-Photo, Photo, Map, Pale-Colour. Settings: Auto or 9 step manual				
Halftone	256 gradations/2 levels (monochrome)				
Copy Features	Electronic sort, Auto Colour Sensing, Auto Paper Selection, Auto Magnification Selection (AMS), image preview/edit, auto tray switching, rotate copy, reserve copy, tandem copy, book copy, margin shift, edge/centre erase, book divide, dual page, cover/insert page, OHP insert, job build, card shot, blank page skip, mirror/reverse, proof, watermark, custom image, job programs.				
Account Control	Up to 1000 users. Supports user-number authentication (on device), login name/password or login name/password (via LDAP server) for Copy, Print, Scan, Fax and document management.				
Output Capacity	Main output tray (top) 250 sheets (face down)				
Firmware Management	Flash ROM (USB), network update capability and 1 to N update with SRDM (Sharp Remote Device Management)				
Configuration Method	Web-based management with user/administrator level login, cloning (1 to N) with SRDM and remote front panel access				
Service/Functions	Remote front panel, access to service logs and click counts				
Accessibility Features	Tilt Front Panel, Adjustment of Key Touch-Send and Speed, Document Feeder Free Stop, Job Programs, Remote Front Panel, Universal Grip for Paper Trays, and Disable Screen Timeout				
Environmental Standards	International Energy Star Program Ver. 1.2, Law on Promoting Green Purchasing, European RoHS				
Power Source	AC 208-240 VAC, 60 Hz, 20 Amps				
Power Consumption	Maximum: 2880 W or less				
Weight	MX6500N/7500N: Approx. 490 lbs.				
Dimensions	Approx. 33.25" (w) x 33.25" (d) x 48" (h)				

Network Printing System (Standard)	
PDL	Standard PCL® 6 compatible Adobe®, PostScript® 3™, optional XPS
Resolution	1200 x 1200 dpi/8-bit processing
Print Speed	65/75 pages per minute (8.5" x 11")
Print Drivers	Windows Server® 2003-2008, Windows XP, Windows XP x64, Windows Server 2003-2008 x64, Windows Vista®, Windows Vista® x64, Windows 7, Windows 7 x64, Windows 8, Windows 8 x64, MAC OSX (including 10.4, 10.5, 10.6, 10.7), all MAC PPD.
Features	Auto configuration, continuous printing, edge-to-edge printing, electronic sorting, N-up printing, duplex printing, transparency inserts, margin shift, image rotation, different cover page, poster print, job bypass print, job retention, confidential print, proof print, user authentication, image stamp and watermarks. Additional features: Multiple pamphlet print, network tandem print, carbon copy print mode, different cover page/last page/other page, form overlay, tab paper settings, tab printing, chapter inserts and page Interleave¹
Direct Printing	File Types: TIFF, JPEG, PCL, PRN, TXT, PDF, Encrypted PDF, PostScript and Windows XPS¹ (FTP, Web page, E-mail and USB)
Resident Fonts	80 outline fonts (PCL), 136 fonts (PS)
Interface	RJ-45 Ethernet 10/100/1000Base-T, USB 2.0
Operating Systems	Windows Server 2003-2012, Windows XP, Windows Vista, Windows 7, Windows 8, MAC OS X10.4, X10.5, X10.6, X10.7, X10.8, Novell® Netware® Unix®, Linux® and Citrix® (XenApp 5.0 6.0, 6.5) and Windows Terminal Services, SAP device types.¹
Network Protocols	TCP/IP (IPv4, IPv6, IPSEC) SSL (HTTP, IPP, FTP), SNMPv3, SMTP, POP3, LDAP, 802.1x for Windows and Unix. LPD and LPR for Unix. IPX/SPX™ for Novell environments. EtherTalk®, AppleTalk® for Macintosh® environments.¹
Printing Protocols	LPR, IPP, IPPS, PAP, Raw TCP (port 9100), FTP and Novell Pserver/Printer
Network Security	IP/MAC address filtering, protocol filtering, port management, user authentication and document administration.¹
Security Standards	IEEE-2600™-2008, DoD (NISTISSP) #11, PIV access control¹

Network Scanning System (Standard)	
Scan Modes	Standard: Colour, monochrome, greyscale
Original Size	11" x 17" (Max.)
Resolution	600 dpi
Output Modes	600 dpi, 400 dpi, 300 dpi, 200 dpi, 150 dpi, 100 dpi
Image Formats	Monochrome: TIFF, PDF, PDF/A, Encrypted PDF, Compact PDF, XPS; Colour: Greyscale, Colour TIFF, JPEG, PDF, Encrypted PDF, XPS
Image Compression	Monochrome Scanning: Uncompressed, G3 (MH), G4 (MR/MMR)
Scan Destinations	Colour/Greyscale: JPEG (high, middle, low), Compact PDF
One-touch Destinations	E-mail, FTP, Folder (SMB), USB
Group Destinations	Up to 2000 (combined scan destinations)
Programs	Up to 500
Max. Jobs	48 (combined)
Protocols	Up to 100
Network Security	TCP/IP and SSL (includes HTTP, SMTP, LDAP, FTP, POP3), SMB, ESMTMP and 802.1x.
	E-mail server user authentication for LDAP and Active Directory

Fiery Colour Print Server (Option)	
Server Type	External Server
System Software	Fiery FS100 Pro
CPU Type	Intel® Core® i5-2400
CPU Speed	3.1 GHz
Memory	4 GB RAM
Hard Disk Drive	1 TB
Operating System	Windows 7 Professional for Embedded Systems x32/x64
Network Connection	RJ-45 10/100/1000Base-T
Power Source	100-240 VAC, 50/60 Hz, 6A
Power Consumption	125 W (Typical)/350 W (Max.)
Dimensions	Approx. 8.5" (w) x 14" (d) x 19.25" (h)
Weight	Approx. 43 lbs.
Options	Fiery Colour Profiler Suite, Fiery Graphic Arts Package Premium Edition, Fiery JobMaster™, Fiery Impose, Fiery Compose, Fiery JobFlow™, Fiery Impose-Compose, Fiery JobMaster-Impose, EFI ES-2000 Spectrophotometer, Fiery Central, Removable Hard Disk and FACI Kit (Fiery Integrated Workstation)

Insertor (Option)	
Paper Capacity	Upper Tray: 200 sheets; Lower Tray: 200 sheets (20 lb. bond)
Paper Weight	16 lb. bond to 100 lb. Bristol (Paper feeding)
Paper Size	Up to 13" x 19"
Power Consumption	70 W or Less
Power Source	24 Volts (Supplied by Main Unit)
Dimensions	21.5" (w) x 30" (d) x 50.5" (h)
Weight	Approx. 51 lbs.

4K 100-Sheet Stapler/Finisher (Option)	
Type	4,000-sheet console stapler finisher (100-sheet stapling)
Output Trays	Upper tray: Moving offset tray (up to 1,500 letter size sheets) Middle tray: 250 sheets (letter size, non-stapled) Lower tray: Moving offset tray (up to 2,450 letter size sheets)
Staple Capacity	Up to 100 sheets (letter/statement)
Staple Media	Plain paper, letter/legal/ledger size or mixed
Staple Positions	1 front, 1 rear, or 2 point stitching
Power Source	120 VAC, 60 Hz, 15 Amps
Power Consumption	200 W/350 W with MXFD10
Weight	Approx.: 134.5 lbs.
Dimensions	Approx.: 30.75" (w) x 30" (d) x 41" (h) (with tray extended)

4K 100-Sheet Stapler/Saddle-Stitch Finisher (Option)	
Type	4,000-sheet console saddle-stitch finisher (100-sheet stapling)
Output Trays	Upper tray: Moving offset tray (up to 1,500 letter size sheets) Middle tray: 250 sheets (letter size, non-stapled) Lower tray: Moving offset tray (up to 2,450 letter size sheets)
Staple Capacity	Up to 100 sheets (letter/statement)
Staple Media	Plain paper, letter/legal/ledger size or mixed
Staple Positions	1 front, 1 rear, or 2 point stitching
Saddle-Stitch	Centre stitch/centre fold (2 staples) letter/legal/ledger sizes
Saddle-Stitch Max. Sets	Up to 5 sets (16-20 sheets)/10 sets (11-15 sheets per set)/15 sets (6-10 sheets per set)/25 sets (1-5 sheets per set)
Power Source	120 VAC, 60 Hz, 15 Amps
Power Consumption	200 W/350 W with MXFD10
Weight	Approx.: 134.5 lbs.
Dimensions	Approx.: 30.75" (w) x 30" (d) x 41" (h) (with tray extended)

Optional Equipment	
MXLC12	3,500-sheet Large Capacity Cassette (letter)¹
MXLCX3N	5,000-sheet Large Capacity 2-Drawer Air-Feed Tray (ledger)¹
MXLMF10	3,000-sheet Large Capacity Cassette (ledger)¹
MXMF10	100-sheet Multi-bypass Tray (for machine)
MXMF11	500-sheet Multi-bypass Tray (for MXLC13)
MXLT10	Long Paper Feeding Tray (requires MXMF10)
MXFN21	4K Stacking 100-sheet Staple Finisher¹
MXFN22	4K Stacking 100-sheet Staple/Saddle-Stitch Finisher¹
MXCF11	2-Tray Insertor Unit¹
MXFD10	Multi-folding Unit¹
MXST10	5,000-sheet Stacker (includes paper cart)
MXCA10	Paper Cart (additional)
MXRB12	Paper Pass Unit (for machine)
MXRB13	Relay Unit¹
MXRB14	Paper Pass Unit (for MXLC13)
MXRB15	Curl Correction Unit¹
MXRB17	Large Capacity Tray Tandem Connecting Kit
MXTM10	Trimmer Unit¹
MXPN13B	3-Hole Punch Unit (for MXFN21/FN22)
MXSCX1	Staple Cartridge (for MXFN22)
MXSCX2	Staple Cartridge (for MXFN21/FN22)
MXTR14	Right Side Exit Tray
MXTU14	Centre Exit Tray
ARSU1	Stamp Unit (requires ARSV1 Stamp Cartridge)
ARSV1	Stamp Cartridge (required for ARSU1)
MXPF10	Bar Code Font Kit
MPXUX1	XPS Expansion Kit
MXEB11	Compact PDF Kit
MXPE10	Fiery Colour Print Server
MPXP10	Fiery Interface Kit
MXEB15	HDD Mirroring Expansion Kit
MXBM50	Plockmatic Booklet Maker
MXGBCX2	GBC SmartPunch Pro
MXFR43U	Commercial Data Security Kit (not available at time of launch)
MXAMX1	Application Integration Module
MXSL10N	Status Indicator
OVENDPS	Generic Vendor Interface Kit

Supplies	
MX62NTBA	Black Toner Cartridge
MX75NTCA	Cyan Toner Cartridge
MX75NTMA	Magenta Toner Cartridge
MX75NTYA	Yellow Toner Cartridge
MX62NVBA	Black Developer
MX62NVSA	Cyan/Magenta/Yellow Developer
MX62NRSA	Drum
MX700HB	Toner Collection Container

¹ Some features may require optional equipment.

² Specification may vary depending on product configuration, machine settings and operating conditions.



Design and specifications subject to change without notice. Sharp, Sharp OSA and all related trademarks are trademarks or registered trademarks of Sharp Corporation and/or its affiliated companies. Windows, Windows Server and Windows Vista are trademarks or registered trademarks of Microsoft Corporation. EFI, Fiery, Electronics For Imaging, the Fiery logo, the EFI logo, FreeForm, Spot-On, WebTools and Command WorkStation are trademarks or registered trademarks of Electronics For Imaging, Inc. All other trademarks are the property of their respective owner.

the **SHARP** experience

see what happens

SHARP

SHARP ELECTRONICS OF CANADA LTD. 335 Britannia Road East, Mississauga, Ontario L4Z 1W9 (905) 890-2100 • www.thesharpxperience.com ©2013 Sharp Electronics of Canada Ltd. Printed in Canada. M7899